

FASCIA LOK

EDGE METAL



Waard Metals Fascia Lok two-piece snap-on fascia for single-ply applications. Waard Metals Fascia Lok provides superior protection against wind and water infiltration. Fascia Lok features 22ga continuous galvalume cleat with pre-punched fastener holes for easy install. Fascia Lok cover features Kynar coated metal in a variety of thickness and substrates. The 10' lengths offer maximum install efficiency and clean aesthetics. Also available are prefabricated inside and outside corners along with spillout scuppers and wall edge terminations. With five standard face dimensions, Fascia Lok offers solutions for most any roof edge.



SIDE VIEW OF FASCIA LOK

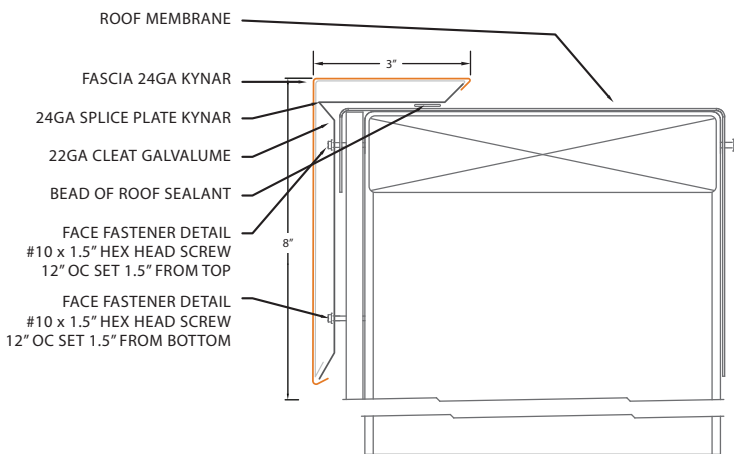

FULL VIEW OF FASCIA LOK

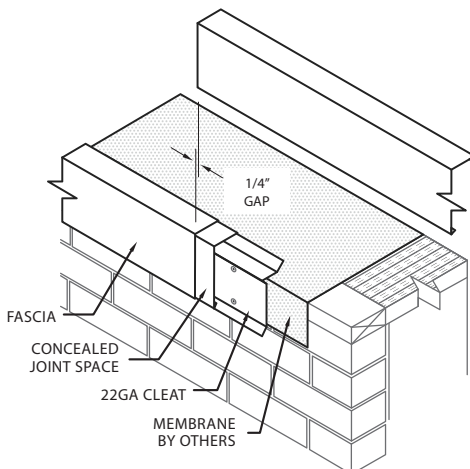

Product Specifications:

Materials and Thickness:

22 and 24 GA Galvalume
.040 and .050 Aluminum

Coatings: Galvalume Plus, Kynar

Application:

- Engineered 22 GA cleat with locator flange and features pre-punched slotted holes 12-in. OC for easy attachment and installation
- Concealed splice plate enhances color continuity, mitigates water infiltration at joints and maintains overall appearance

Performance Standards:

- ANSI/SPRI/FM4435 ES-1 Tested
- 25-year wind warranty
- 25-year finish warranty

MATERIAL:

22 & 24 GA Steel and .040 & .050 AL

DIMENSIONS:

4" face | 5" face | 6" face | 7" face | 8" face

WIND WARRANTY:

120mph

* INSIDE CORNERS, OUTSIDE CORNERS, AND SCUPPERS AVAILABLE

CLAD WITH CONFIDENCE.

CALL NOW: 641.629.0878

SALES@WAARDMETALS.COM
WAARDMETALS.COM